



CORTICAL SCREWS (Self Tapping)

Implant material : Stainless Steel

	Cortical Screws mm	Small Cortical Screws mm
Threaded Diameter	4.5	3.5
Head Diameter	8	6
Hexagonal Socket	3.5	2.5
Threaded Length	Full	Full



LENGTH mm	CODE (Cortical)	CODE (Small Cortical)
10		20110100035
12		20110120035
14	20210140045	20110140035
16	20210160045	20110160035
18	20210180045	20110180035
20	20210200045	20110200035
22	20210220045	20110220035
24	20210240045	20110240035
26	20210260045	20110260035
28	20210280045	20110280035
30	20210300045	20110300035
32	20210320045	20110320035
34	20210340045	20110340035
36	20210360045	20110360035
38	20210380045	20110380035
40	20210400045	20110400035
42	20210420045	20110420035
44	20210440045	20110440035
46	20210460045	20110460035
48	20210480045	20110480035
50	20210500045	20110500035
52	20210520045	
54	20210540045	
56	20210560045	
58	20210580045	
60	20210600045	
62	20210620045	
64	20210640045	
66	20210660045	
68	20210680045	
70	20210700045	



CANCELLOUS SCREWS (Self Tapping)

Implant material : Stainless Steel

Cancellous Screws (Spongios)

Small Cancellous Screws (Navicular)

Threaded Diameter	6.5 mm	6.5 mm	6.5 mm
Head Diameter	8 mm	8 mm	8 mm
Hexagonal Socket	3.5 mm	3.5 mm	3.5 mm
Threaded Length	16 mm	32 mm	Full

4 mm	4 mm
6 mm	6 mm
2.5 mm	2.5 mm
1/2	Full



Cancellous Screws (Spongios)

Small Cancellous Screws (Navicular)

Length mm	16 mm	32 mm	Full
25	20410251665		
30	20410301665		20410300065
35	20410351665		20410350065
40	20410401665		20410400065
45	20410451665	20410453265	20410450065
50	20410501665	20410503265	20410500065
55	20410551665	20410553265	20410550065
60	20410601665	20410603265	20410600065
65	20410651665	20410653265	20410650065
70	20410701665	20410703265	20410700065
75	20410751665	20410753265	20410750065
80	20410801665	20410803265	20410800065
85	20410851665	20410853265	20410850065
90	20410901665	20410903265	20410900065
95	20410951665	20410953265	20410950065
100	20411001665	20411003265	20410000065
105	20411051665	20411053265	20411050065
110	20411101665	20411103265	20411100065

Length mm	1/2 Thread	Full Thread
10	20410100540	20410100040
12	20410120540	20410120040
14	20410140540	20410140040
16	20410160540	20410160040
18	20410180540	20410180040
20	20410200540	20410200040
22	20410220540	20410220040
24	20410240540	20410240040
26	20410260540	20410260040
28	20410280540	20410280040
30	20410300540	20410300040
35	20410350540	20410350040
40	20410400540	20410400040
45	20410450540	20410450040
50	20410500540	20410500040



MALLEOLAR SCREWS

Implant material : Stainless Steel

Malleolar Screws	
Threaded Diameter	4.5 mm
Head Diameter	8 mm
Hexagonal Socket	3.5 mm
Threaded Length	1/2

LENGTH mm	CODE
20	20310200545
25	20310250545
30	20310300545
35	20310350545
40	20310400545
45	20310450545
50	20310500545
55	20310550545
60	20310600545
65	20310650545
70	20310700545



Screw Washer

Ø 10	20010000010
Ø 13	20010000013





NARROW PLATES TIBIA

Implant material : Stainless Steel
Profile : 12x 4 mm
Distance between holes : 16 mm and 25 mm
Fixation with 4,5 & 6,5 mm screws



HOLES	ROUND HOLES CODE	DCP HOLES CODE	LENGTH mm
4	30111000004	30112000004	71
5	30111000005	30112000005	87
6	30111000006	30112000006	103
7	30111000007	30112000007	119
8	30111000008	30112000008	135
9	30111000009	30112000009	151
10	30111000010	30112000010	167
11	30111000011	30112000011	183
12	30111000012	30112000012	199
13	30111000013	30112000013	215
14	30111000014	30112000014	231
15	30111000015	30112000015	247
16	30111000016	30112000016	263
17	30111000017	30112000017	279
18	30111000018	30112000018	295



THIN NARROW PLATES (SMALL FRAGMENT)

Implant material : Stainless Steel

Profile : 10x 3 mm

Distance between holes : 12 mm and 16 mm

Fixation with 3,5 mm screws



HOLES	ROUND HOLES CODE	DCP HOLES CODE	LENGTH mm	ACP HOLES CODE	LENGTH mm
4	30511000004	30512000004	50	30513000004	53
5	30511000005	30512000005	62	30513000005	64
6	30511000006	30512000006	74	30513000006	73
7	30511000007	30512000007	86	30513000007	84
8	30511000008	30512000008	98	30513000008	93
9	30511000009	30512000009	110	30513000009	104
10	30511000010	30512000010	122	30513000010	113
12	30511000012	30512000012	146	30513000012	133



BROAD COMPRESSION PLATES (FEMUR)

Implant material : Stainless Steel

Profile : 16x 5 mm

Distance between holes : 12 mm and 16 mm

Fixation with 4,5 & 6,5 mm screws



LC-DCP

HOLES	ROUND HOLES CODE	DCP HOLES CODE	LC-DCP HOLES CODE	LENGTH mm
4	30111000004	30112000004	30113000004	71
5	30111000005	30112000005	30113000005	87
6	30111000006	30112000006	30113000006	103
7	30111000007	30112000007	30113000007	119
8	30111000008	30112000008	30113000008	135
9	30111000009	30112000009	30113000009	151
10	30111000010	30112000010	30113000010	167
11	30111000011	30112000011	30113000011	183
12	30111000012	30112000012	30113000012	199
13	30111000013	30112000013	30113000013	215
14	30111000014	30112000014	30113000014	231
15	30111000015	30112000015	30113000015	247
16	30111000016	30112000016	30113000016	263
17	30111000017	30112000017	30113000017	279
18	30111000018	30112000018	30113000018	295



BROAD LENGTHENING PLATES (FOR FEMUR)

Implant material : Stainless Steel
Profile : 16x 5 mm
Distance between holes : 12 mm
Fixation with 4,5 & 6,5 mm screws



Total Lengthening	8 Holes	Length mm
30 mm	30311300008	135
40 mm	30311400008	145
50 mm	30311500008	155
60 mm	30311600008	165

Total Lengthening	10 Holes	Length mm
50 mm	30311500010	179
60 mm	30311600010	189
70 mm	30311700010	199
80 mm	30311800010	209



NARROW LENGTHENING PLATES (FOR TIBIA)

Implant material : Stainless Steel
Profile : 12x 4 mm
Distance between holes : 12 mm
Fixation with 4,5 & 6,5 mm screws



Total Lengthening	8 Holes
30 mm	30411300008
40 mm	30411400008
50 mm	30411500008
60 mm	30411600008
70 mm	30411700008



SEMI TUBULAR PLATES (For Fibula and Radius)

Implant material : Stainless Steel
Profile : 12x 1 mm (Half Tube)
Distance between holes : 16 mm and 26 mm
Fixation with 4,5 mm screws

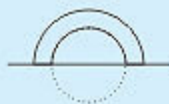

HOLES	CODE	LENGTH mm
3	30611000003	55
4	30611000004	71
5	30611000005	87
6	30611000006	103
7	30611000007	119
8	30611000008	135
9	30611000009	151
10	30611000010	167
11	30611000011	183
12	30611000012	199

1/3 TUBULAR PLATE (For Fibula and Radius)

Implant material : Stainless Steel
Profile : 9x 1 mm
Distance between holes : 12 mm and 16 mm
Fixation with 3,5 mm screws



HOLES	CODE	LENGTH mm
3	30711000003	37
4	30711000004	49
5	30711000005	61
6	30711000006	73
7	30711000007	85
8	30711000008	97
9	30711000009	109
10	30711000010	121
11	30711000011	133
12	30711000012	145



STRAIGHT RECONSTRUCTION PLATE (3.5 mm and 4.5 mm)

Implant material : Stainless Steel

Profile : (3,5 mm) ... 10 x 3 mm

(4,5 mm) ... 12 x 3 mm

Distance between holes : 12 mm and 16 mm

Fixation with 3,5 & 4,5 mm screws



HOLES	3.5 mm Reconstruction Plates	Length mm	4.5 mm Reconstruction Plates	Length mm
4	31011000004	48	30911000004	62
5	31011000005	60	30911000005	78
6	31011000006	72	30911000006	94
7	31011000007	84	30911000007	120
8	31011000008	96	30911000008	136
9	31011000009	108	30911000009	152
10	31011000010	120	30911000010	168
11	31011000011	132	30911000011	184
12	31011000012	144	30911000012	200
13	31011000013	156	30911000013	216
14	31011000014	168	30911000014	232
15	31011000015	180	30911000015	248
16	31011000016	192	30911000016	264
17	31011000017	204	30911000017	280
18	31011000018	216	30911000018	296
19	31011000019	228	30911000019	312
20	31011000020	240	30911000020	318



CURVED PELVIC RECONSTRUCTION PLATE (3.5 mm)

Implant material : Stainless Steel
Profile : (3,5 mm) ... 10 x 3 mm
Distance between holes : 12 mm
Fixation with 3,5 mm screws



HOLE	3,5 mm Reconstruction Plates	LENGTH mm
4	31011010004	48
5	31011010005	60
6	31011010006	72
7	31011010007	84
8	31011010008	96
9	31011010009	108
10	31011010010	120
11	31011010011	132
12	31011010012	144
13	31011010013	156
14	31011010014	168
15	31011010015	180
16	31011010016	192
17	31011010017	204
18	31011010018	216

SHERMAN PLATES



Implant material : Stainless Steel
Fixation with 4,5 mm screws



ANATOMICAL BONE PLATES (FOR DISTAL TIBIA LATERAL AND MEDIAL)

Implant material : Stainless Steel

Profile : Width of shaft : 16 mm

Width of head : 25 mm

Fixation with 4,5 & 6,5 mm screws



HOLES	CODE	LENGTH mm	TYPE
7	31315000107	122	Lateral - R
7	31315000207	122	Medial - R
7	31316000107	122	Lateral - L
7	31316000207	122	Medial - L
9	31315000109	158	Lateral - R
9	31315000209	158	Medial - R
9	31316000109	158	Lateral - L
9	31316000209	158	Medial - L
11	31315000111	194	Lateral - R
11	31315000211	194	Medial - R
11	31316000111	194	Lateral - L
11	31316000213	194	Medial - L
13	31315000113	230	Lateral - R
13	31315000213	230	Medial - R
13	31316000113	230	Lateral - L
13	31316000213	230	Medial - L



ANATOMICAL BONE PLATES (KP DISTAL TIBIA)

Implant material : Stainless Steel

Profile : 12 x 2,5 mm

Fixation with 4,5 mm screws





ANATOMICAL BONE PLATES (FOR PROXIMAL TIBIA LATERAL AND MEDIAL)

Implant material : Stainless Steel

Profile : Width of shaft : 16 mm

Width of head : 25 mm

Fixation with 4,5 & 6,5 mm screws



HOLES	CODE	LENGTH mm	TYPE
7	31415000107	122	Lateral - R
7	31415000207	122	Medial - R
7	31416000107	122	Lateral - L
7	31416000207	122	Medial - L
9	31415000109	158	Lateral - R
9	31415000209	158	Medial - R
9	31416000109	158	Lateral - L
9	31416000209	158	Medial - L
11	31415000111	194	Lateral - R
11	31415000211	194	Medial - R
11	31416000111	194	Lateral - L
11	31416000213	194	Medial - L
13	31415000113	230	Lateral - R
13	31415000213	230	Medial - R
13	31416000113	230	Lateral - L
13	31416000213	230	Medial - L



ANATOMICAL BONE PLATES (FOR DISTAL FEMUR LATERAL)

Implant material : Stainless Steel
Profile : Width of shaft : 16 mm
 Width of head : 25 mm
Fixation with 4,5 & 6,5 mm screws

HOLES	CODE	LENGTH mm	TYPE
7	31515000107	122	Lateral - R
7	31516000107	122	Lateral - L
9	31515000109	158	Lateral - R
9	31516000109	158	Lateral - L
11	31515000111	194	Lateral - R
11	31516000111	194	Lateral - L
13	31515000113	230	Lateral - R
13	31516000113	230	Lateral - L

ANATOMICAL BONE PLATES (FOR PROXIMAL FEMUR LATERAL)

Implant material : Stainless Steel
Profile : Width of shaft : 16 mm
 Width of head : 25 mm
Fixation with 4,5 & 6,5 mm screws





SPECIAL PLATES (FOR FEMUR)

COBRA HEAD PLATES

Implant material : Stainless Steel
Fixation with 4,5 & 6,5 mm screws

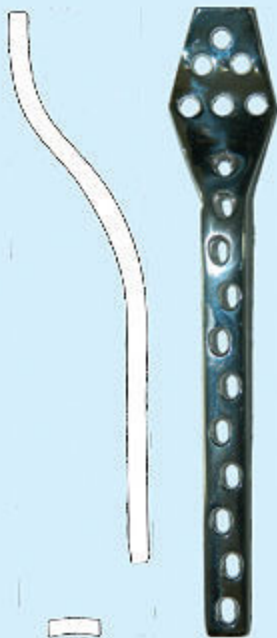

CONDYLAR BUTTRESS PLATES

Implant material : Stainless Steel
Fixation with 4,5 & 6,5 mm screws

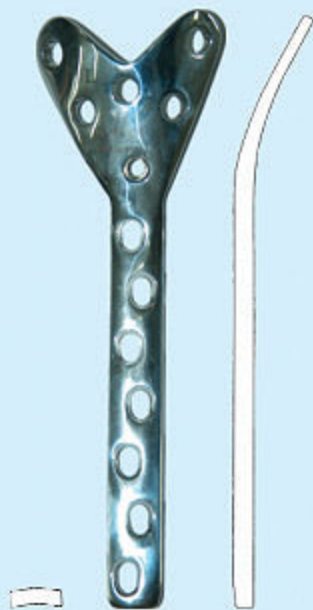



SPOON PLATES (FOR TIBIA)

Implant material : Stainless Steel
Fixation with 4,5 & 6,5 mm screws



HOLES	CODE	LENGTH mm
5	32410000005	100
6	32410000006	120

CLOVERLEAF PLATES (FOR TIBIA)

Implant material : Stainless Steel
Fixation with 4,5 & 6,5 mm screws

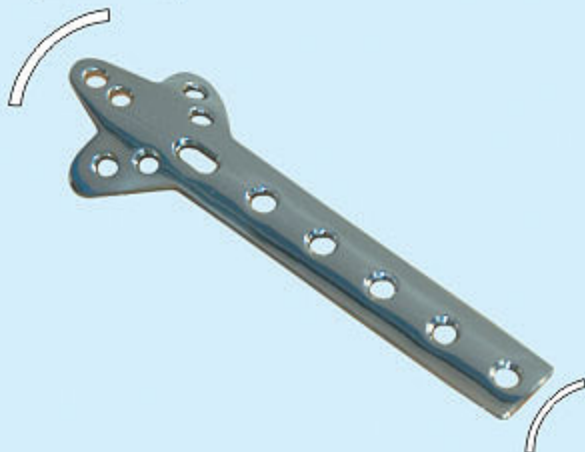



ANATOMICAL BONE PLATES (FOR TIBIA)

L PLATES

Implant material : Stainless Steel
Fixation with 4,5 & 6,5 mm screws



L BUTTRESS PLATES

Implant material : Stainless Steel
Fixation with 4,5 & 6,5 mm screws





ANATOMICAL BONE PLATES (FOR HUMERUS)

Y PLATE

Implant material : Stainless Steel
Fixation with 4,5 & 6,5 mm screws

HOLES	CODE	LENGTH mm
3	32315000003	82 - R
3	32316000003	82 - L
5	32315000005	112 - R
5	32316000005	112 - L
8	32315000008	157 - R
8	32316000008	157 - L



STRAIGHT Y PLATE

Implant material : Stainless Steel
Fixation with 4,5 & 6,5 mm screws





SMALL T PLATE (FOR DISTAL RADIUS)

Implant material : Stainless Steel

Profile : 10 x 1,5 mm

Width of head : 23 mm and 24 mm

Fixation with 3,5 & 4 mm screws



HOLES	CODE	LENGTH mm	LENGTH mm
3	32815000003	45	Right - Volar
3	32816000003	45	Left - Volar
3	32915000003	45	Right - Dorsal
3	32916000003	45	Left - Dorsal
4	32815000004	56	Right - Volar
4	32816000004	56	Left - Volar
4	32915000004	56	Right - Dorsal
4	32916000004	56	Left - Dorsal
5	32815000005	67	Right - Volar
5	32816000005	67	Left - Volar
5	32915000005	67	Right - Dorsal
5	32916000005	67	Left - Dorsal
6	32815000006	78	Right - Volar
6	32816000006	78	Left - Volar
6	32915000006	78	Right - Dorsal
6	32916000006	78	Left - Dorsal





HUMERUS PLATE

Implant material : Stainless Steel

Profile : 12 x 3 mm

Distance between holes : 16 mm and 25 mm

Fixation with 4,5 mm screws



HOLES	ROUND HOLES	DCP HOLES	LENGTH mm
4	31711000004	31712000004	71
5	31711000005	31712000005	87
6	31711000006	31712000006	103
7	31711000007	31712000007	119
8	31711000008	31712000008	135
9	31711000009	31712000009	151
10	31711000010	31712000010	167
11	31711000011	31712000011	183
12	31711000012	31712000012	199



ANATOMIC MAY PLATE (Proximal Humerus)

Implant material : Stainless Steel
Fixation with 4,5 & 6,5 mm screws

HOLES	CODE
5	31710000005
8	31710000008



EPICONDYLAR PLATE (Distal Humerus)

Implant material : Stainless Steel
Fixation with 3,5 mm screw





ANATOMICAL BONE PLATES (FOR TIBIA)

T PLATE

Implant material : Stainless Steel
Fixation with 4,5 & 6,5 mm screws



T BUTTRESS PLATE

Implant material : Stainless Steel
Fixation with 4,5 & 6,5 mm screws



HOLES		
3	31910000003	68
4	31910000004	84
5	31910000005	100
6	31910000006	116
8	31910000008	148

HOLES		
4	32110000004	84
5	32110000005	100
6	32110000006	116
7	32110000007	132
8	32110000008	148



ANGLED BLADE PLATES - 130°

Implant material : Stainless Steel

Profile : 16x6 mm

Fixation with 4,5 & 6,5 mm screwsp



HOLES	BLADE LENGTH mm	DCP HOLES	SHAFT LENGTH mm	ROUND HOLES	SHAFT LENGTH mm
4	60 - 110	33812306004	73	33811306004	72
5	60 - 110	33812306005	89	33811306005	88
6	60 - 110	33812306006	105	33811306006	104
7	60 - 110	33812306007	121	33811306007	120
8	60 - 110	33812306008	137	33811306008	136
9	60 - 110	33812306009	153	33811306009	152
10	60 - 110	33812306010	169	33811306010	168
11	60 - 110	33812306011	185	33811306011	184
12	60 - 110	33812306012	201	33811306012	200
13	60 - 110	33812306013	217	33811306013	216
14	60 - 110	33812306014	233	33811306014	232



ANGLED BLADE PLATES - 95°

Implant material : Stainless Steel

Profile : 16x6 mm

Fixation with 4,5 & 6,5 mm screws



HOLES	BLADE LENGTH mm	DCP HOLES	SHAFT LENGTH mm	ROUND HOLES	SHAFT LENGTH mm
5	50 - 100	33812955005	92	33811955005	92
7	50 - 100	33812955007	124	33811955007	124
9	50 - 100	33812955009	156	33811955009	156
12	50 - 100	33812955012	204	33811955012	204
14	50 - 100	33812955014	236	33811955014	236
16	50 - 100	33812955016	268	33811955016	268
18	50 - 100	33812955018	284	33811955018	284



ANGLED BLADE PLATES - 90° (FOR ADULTS)

Implant material : Stainless Steel

Profile : 16x6 mm

Fixation with 4,5 mm screws



BLADE LENGTH mm	CODE
40	33612904004
45	33612904504
50	33612905004
40	33612904004
45	33612904504
50	33612905004
55	33612905504

ANGLED BLADE PLATES - 90° (FOR INFANTS)

Implant material : Stainless Steel

Shaft Profile : 10,5x2,5 mm

Blade Profile : 8,2 x 2,2 mm

Fixation with 4,5 mm screws



BLADE LENGTH mm	DISPLACEMENT	CODE
25	7	33312902503
32	7	33312903203
25	12	33412902503
32	12	33412903203



ANGLED BLADE PLATES - 90° (FOR CHILDREN)

Implant material : Stainless Steel

Shaft Profile : 10,5x2,5 mm

Blade Profile : 11,5 x 4 mm

Fixation with 4,5 mm screws



BLADE LENGTH mm	DISPLACEMENT mm	ROUND HOLES 3	DCP HOLES 3
35	8	33511903003	33512903003
45	8	33511904503	33512904503



DYNAMIC HIP SCREW AND PLATE 135° DHS

Implant material : Stainless Steel
 Shaft Profile : 19x6 mm
 Barrel Length : 38 mm
 Angulation shaft/barrel : 135°
 Fixation with 4,5 & 6,5 mm screws



HOLES	ROUND HOLES	LENGTH mm	DCP HOLES	LENGTH mm
3	33211350003	76	33212350003	62
4	33211350004	102	33212350004	78
5	33211350005	127	33212350005	94
6	33211350006	152	33212350006	110
7	33211350007	178	33212350007	126
8	33211350008	203	33212350008	142
9	33211350009	229	33212350009	158
10	33211350010	254	33212350010	174
12	33211350012	305	33212350012	206
14	33211350014	356	33212350014	238
16	33211350016	407	33212350016	270

LAG SCREWS

Implant material : Stainless Steel
 Thread Length : 21 mm
 Diameter of Shaft : 8 mm



COMPRESSION SCREW

20810250004



HOLES	ROUND HOLES
50	20710500000
55	20710550000
60	20710600000
65	20710650000
70	20710700000
75	20710750000
80	20710800000
85	20710850000
90	20710900000
95	20710950000
100	20710000000
105	20710050000
110	20710100000



DYNAMIC CONDYLAR SCREW AND PLATE 95° DCS

Implant material : Stainless Steel
Shaft Profile : 16x6 mm
Barrel Length : 25 mm
Angulation shaft/barrel : 95°
Fixation with 4,5 & 6,5 mm screws



HOLES	DCP HOLES	LENGTH mm
5	33212950005	92
6	33212950006	108
7	33212950007	124
8	33212950008	140
9	33212950009	156
10	33212950010	172
12	33212950012	204
14	33212950014	236
16	33212950016	268

LAG SCREWS

Implant material : Stainless Steel
Thread Length : 21 mm
Diameter of Shaft : 8 mm



COMPRESSION SCREW

20810250004



HOLES	ROUND HOLES
50	20710500000
55	20710550000
60	20710600000
65	20710650000
70	20710700000
75	20710750000
80	20710800000
85	20710850000
90	20710900000
95	20710950000
100	20710000000
105	20710050000
110	20710100000